



Cold Air Induction kit for Ford Falcon models BA

PLEASE READ ENTIRE INSTALATION MANUAL AND TERM & CONDITIONS BEFORE COMENCING FITTMENT.

Operation:

By introducing a secondary cold fresh air path into the stock airbox, airflow is greatly increased when fitted in conjunction with a high flow filter medium such as the K&N or BMC filter as optioned in this kit.

A degree of force air induction is achieved through the front of the grill opening on the vehicle while in forward motion, the amount of forced air is dependant on the vehicle speed.

Tools Required:

Socket set
Screwdriver set
7/64 Drill bit
83mm hole saw or other means of making 83mm diameter hole.
Half round file for clean up of 83mm hole.

Installation:

Install the two small plastic insert plugs into the pre stamped holes located on top of the radiator support panel. These will be used later to screw down the intake duct.

Next do a trial fit so as to get the correct location of the intake duct adapter onto the factory air box. Do this by leaving the factory components in situation and assembling the adapter and the air intake tube into place and do as per following photo steps.

Photo installation procedure:

- 1: Pre-fit air intake tube to intake adapter and but up against filter housing.**



- 2: Secure air intake tube to radiator support panel using two of the six black screws provided with the kit.**



- 3: Adjust the air intake adapter so it is at its best sealing position on the filter housing. Mark with a scribe or small drill bit the location of the four mounting/attachment screws.**



- 4: Remove the air intake tube, adapter and the filter housing from the vehicle. Drill out the four mounting screw holes with a 7/64-drill bit using the adapter as a template to drill the holes if necessary.**



- 5:** Using four of the six black self-tapping screws secure the adapter to the filter housing. Using the adapter as a template, scribe the inner circumference of the adapter so as to use as a guide when cutting out 83mm hole.



- 6:** Using a 83mm hole saw or other safe means, cut an opening in the filter housing that will match up with the adapter opening. It may be necessary to remove the adapter from the filter housing when doing this.
Clean up any rough edges of the opening before refitting adapter.

- 7: **Re-install the filter housing onto its bracket, fit intake tube to the adapter and secure.**



- 8: **Install K&N or B.M.C. high flow air cleaner and place filter housing lid.**



Completed Air Intake installation

Assembly breakdown of BA Falcon air box with adapter and tube:

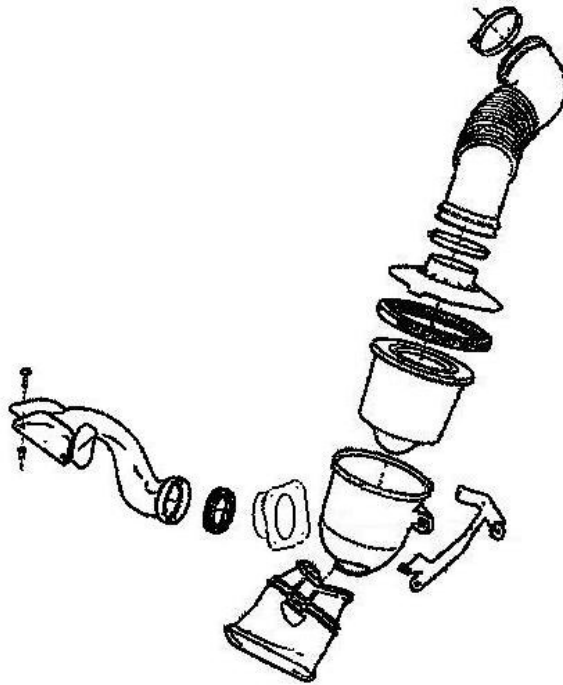

TERMS OF USE, WARRANTY AND LIABILITY WAIVER

While all care was taken to compile this installation manual, Batten's Performance Tuning does not take responsibility for damages to vehicle systems arising from incorrect installation of this kit.

It is recommended that this kit be fitted by a person with sound competent mechanical background knowledge in the automotive industry.

Parts warranted are those that fail due to poor product control or workmanship and not those that have failed due to incorrect fitment, indirect failure of another component or modification to this kits original fitment plan.

Failing to return the complete contents of this kit back to Batten's Performance Tuning within 14 days of purchase in an unused condition for refund, tells us that you have accepted these Terms and conditions of sale.

Battens Performance Tuning
Unit 13/ 9 Inspiration Drive, Wangara, WA 6065
www.bptmotorsport.com